

PLML 200X200 2X75

Plenum di immissione/estrazione in lamiera zincata, 2 attacchi laterali Ø80mm, completo di chiusura anti-malta e 2 tappi (per CNDFLB 75/63) per bocchette BCRG 125-150.

Modello	PLML 200X200 2X75
Codice	000767

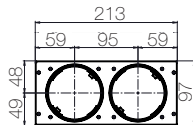
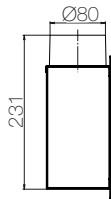
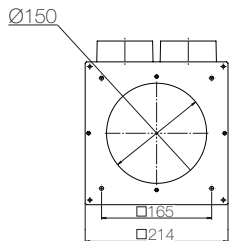

Dimensioni in mm

